

LTR	DESCRIPTION	DATE	CHANGE	APPL'
Δ				
Δ				
Δ				

符合ROHS标准

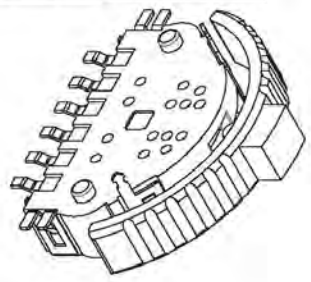
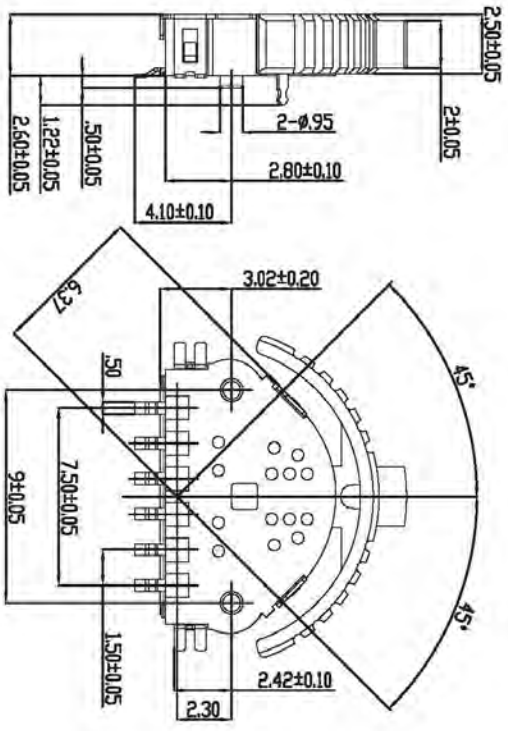
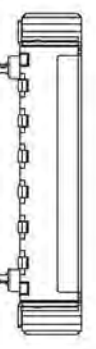
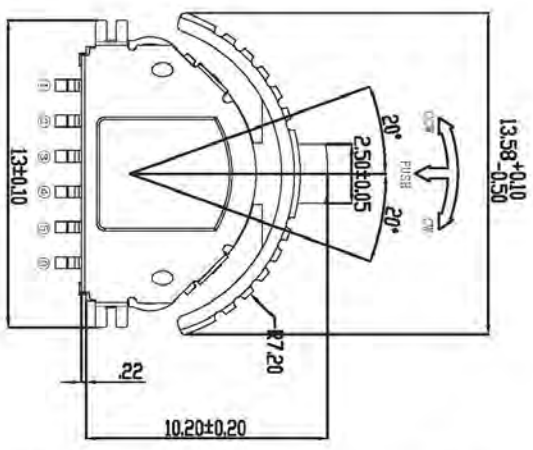
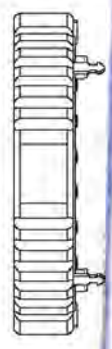
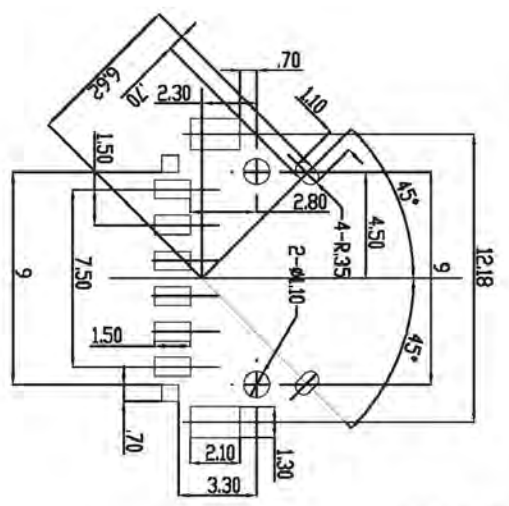
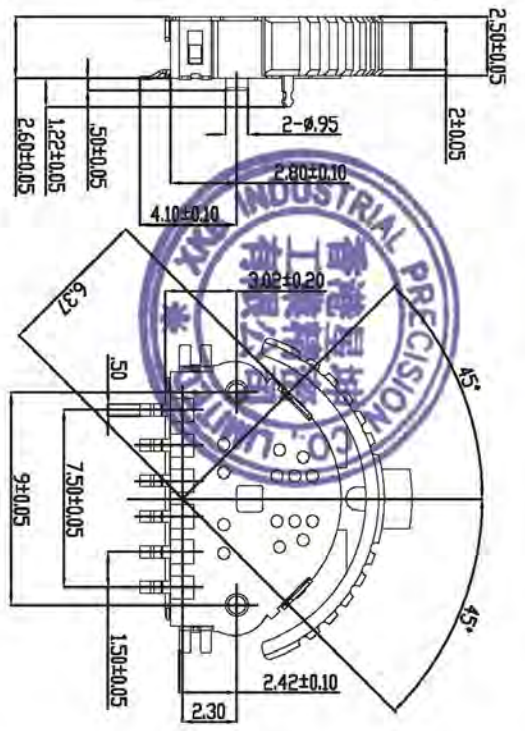

项目	规格
额定范围:	0.1A DC12V
绝缘电阻:	100MΩ min.(DC100V)
耐压强度:	AC100V/50/60Hz for 1 minute
机械寿命:	100,000 cycles
操作温度:	-10°c ~ +60°c
操作力度:	摆动 80 ± 50gF
	直拔 250 ± 50gF

序号	名称	数量	材料	镀涂	颜色
5	弹簧	2	不锈钢		银白色
4	接触簧片	1	复银铜		银白色镀银
3	盖子	1	不锈钢		银白色
2	底座	1	PA46		黑色与镀银
1	主轴	1	PA46		黑色

KKB INDUSTRIAL PRECISION CO., LIMITED

For and on behalf of SINGAPORES
KKB INDUSTRIAL PRECISION CO., LIMITED
 香港精工工業有限公司

DATE: _____
 PRODUCT: _____

DWG NO: **TM-2122**
 SCALE: _____
 REV: _____

ALL DIMENSIONS ARE IN MILLIMETER
 TOLERANCES CLASS: _____
 %: ORDER DIMENSION &: C.P.K

USE	CM	MM	IN
①	<input type="checkbox"/>	<input type="checkbox"/>	<input type="checkbox"/>
②	<input type="checkbox"/>	<input type="checkbox"/>	<input type="checkbox"/>
③	<input type="checkbox"/>	<input type="checkbox"/>	<input type="checkbox"/>
④	<input type="checkbox"/>	<input type="checkbox"/>	<input type="checkbox"/>
⑤	<input type="checkbox"/>	<input type="checkbox"/>	<input type="checkbox"/>
⑥	<input type="checkbox"/>	<input type="checkbox"/>	<input type="checkbox"/>
⑦	<input type="checkbox"/>	<input type="checkbox"/>	<input type="checkbox"/>
⑧	<input type="checkbox"/>	<input type="checkbox"/>	<input type="checkbox"/>
⑨	<input type="checkbox"/>	<input type="checkbox"/>	<input type="checkbox"/>
⑩	<input type="checkbox"/>	<input type="checkbox"/>	<input type="checkbox"/>

CHEK _____
 AUTHORIZED SIGNATURE(S) _____

A B C D E F G